

# SERIE CS

(ISO - 3320)



Características ●

Tabla para la determinación ●

Tabla zona de Euler ●

Designación del cilindro ●

Lista de materiales ●

## TABLAS DE DIMENSIONES

Ejecución base Tipo XS ●

Charnela macho Tipo DS ●

Brida delantera Tipo AS ●

Brida trasera Tipo BS ●

Fijación por patas Tipo ES ●

Fijación para muñones Tipo FS ●

Charnela rótula trasera Tipo GS ●

Cilindro de doble vástago Tipo XD ●

Cilindro de doble vástago Tipo AD ●

Cilindro de doble vástago Tipo ED ●

Muñones intermedios Tipo FD ●

## ACCESORIOS

Arrastrador macho Tipo AM ●

Horquilla (ISO-8133) Tipo AH ●

Cabeza de rótula Tipo AR ●

Cabeza de rótula (DIN-24555/ISO-8133) Tipo A ●



Volver  
Series Fabricación



Volver  
Página Principal



# CILINDROS HIDRAULICOS HYDRAULIC CYLINDERS

# CS

ISO 3320

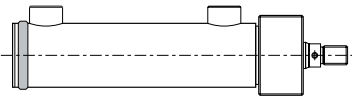

**XS - Ejecución Base**  
XS - Bore Cylinder

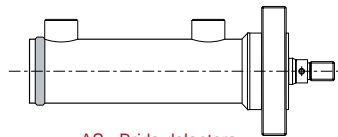

**AS - Brida delantera**  
AS - Front flange mounting

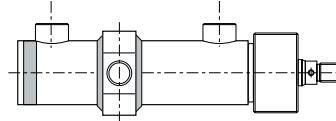

**DS - Charnela trasera**  
DS - Eye mounting

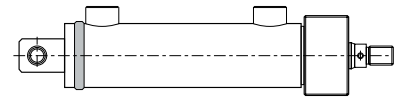

**FS - Fijación muñones**  
FS - Head trunnion mounting

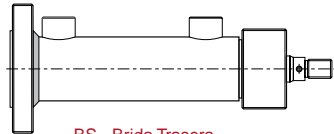

**BS - Brida Trasera**  
BS - Rear flange mounting

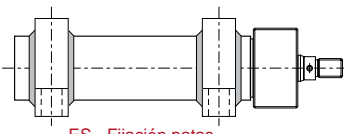

**ES - Fijación patas**  
ES - Foot mounting

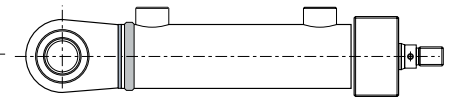

**GS - Charnela rótula**  
GS - Spherical eye mounting

## • CARACTERISTICAS •

Norma	ISO - 3320									
Tipo de construcción	Tapas y fijaciones soldadas									
Presión mínima	15 bars									
Presión nominal	210 bars									
Presión de prueba	250 bars									
Posición de montaje	s/pedido									
Temperatura ambiente	-20°C + 80°C con juntas tipo M									
Temperatura de fluido	-20°C + 80°C con juntas tipo M									
Fluido	Aceite mineral CETOP RP 91 - H									
Viscosidad	12... 90 m.m. /s									
Filtración	Grado de filtración según NAS 1638									
Tipo de estanqueidad	Ver código para pedido									
Ø Camisa - Pistón (m/m)	32	40	50	63	80	100	125	160	200	250
Ø Vástago	16	22/28	28/36	36/45	45/56	56/70	70/90	90/110	110/140	140/180
Velocidad max. (m/s) tipo M	0,5			0,4			0,25			
Velocidad max. (m/s) tipo T	1						0,7			
Tolerancia de carrera	Según tablas interiores • T •									

## • SPECIFICATIONS •

Norm	ISO-3320									
Sort of construction	Lids and welded fixings									
Minimal pressure	15 bar									
Nominal pressure	210 bar									
Test pressure	250 bars									
Assembly position	As desired									
Ambient temperature	-20 C + 80 C with together type M									
Fluid temperature	-20 C + 80 C with together type M									
Fluid	Mineral oil CETOP RP 91 - H									
Viscosity	12... 90 m.m. / s									
Filtration	Dil contamination NAS 1638									
Sort of estanqueidad	See ordering code									
Shirt-Piston (m/ m)	32	40	50	63	80	100	125	160	200	250
Scion	16	22/28	28/36	36/45	45/56	56/70	70/90	90/110	110/140	140/180
Speed max. (m/ s) type M	0,5			0,4			0,25			
Speed max. (m/ s) type T	1						0,7			
Stroke tolerance	In reference with dimensions table									

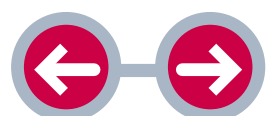



• **DETERMINACION DEL CILINDRO** •  
• **DETERMINATION OF THE CYLINDER** •

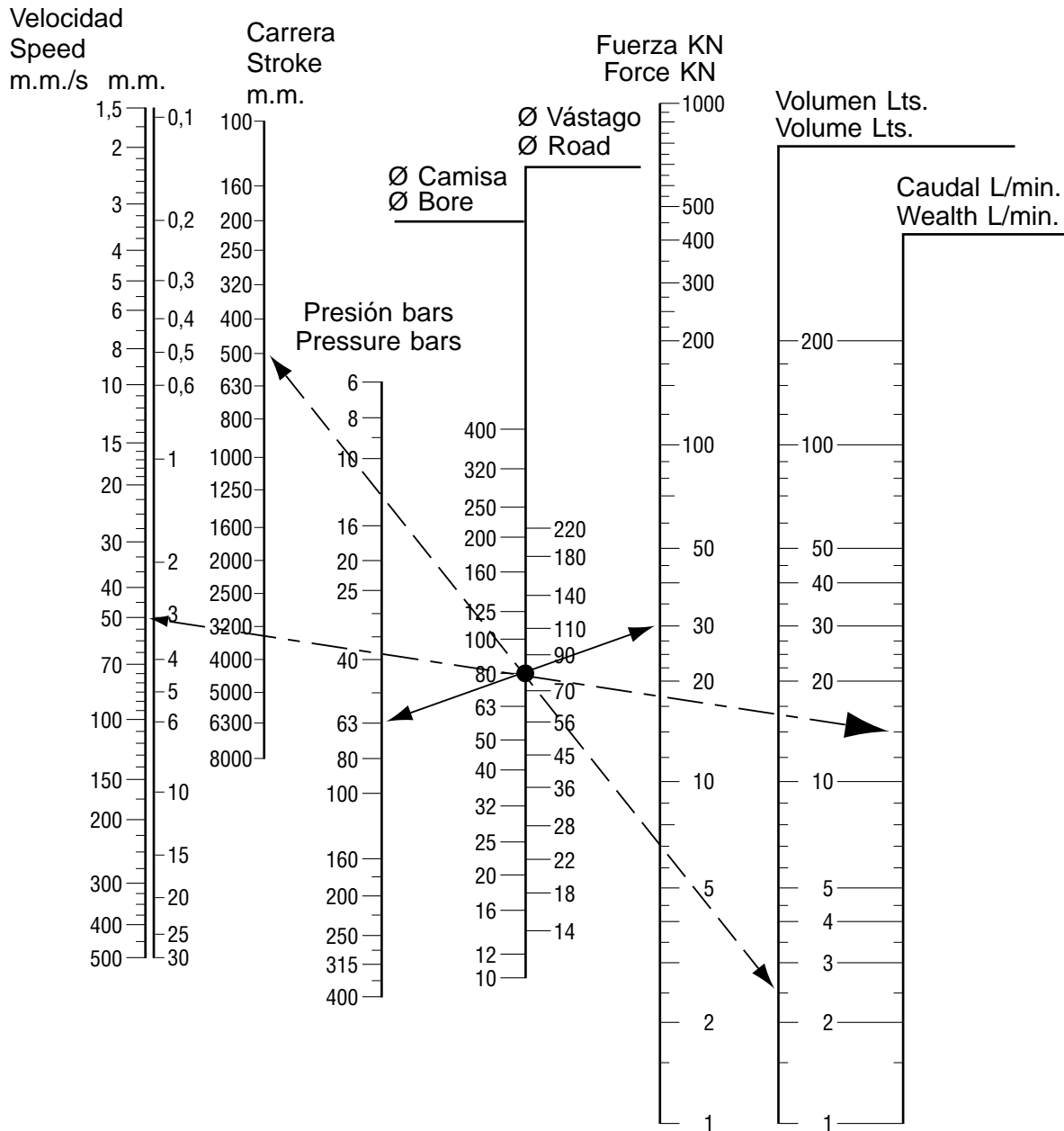

**DIAMETROS. PASOS, SECCIONES y FUERZAS.**  
**DIAMETERS. STEPS, SECTIONS and FORCES.**

DIAMETROS	32/16	40/22	50/28	60/30	63/36	70/30	80/45	90/45	100/56	120/70	125/70	140/90	160/90	200/110	250/140
Sección total	8,04	12,56	19,36	28,27	31,17	38,48	50,26	63,61	78,53	113,09	122,71	153,93	201,06	314,16	490,87
Sección Vástago N.	2,01	3,80	6,15	7,06	10,17	7,06	15,90	15,90	24,63	38,48	38,48	63,61	63,61	95,03	153,90
Sección ANULAR	6,03	8,78	13,48	21,21	21	31,42	34,36	47,41	53,90	74,61	84,23	90,32	137,45	219,13	336,97

DIAMETROS	32/20	40/28	50/36	60/30	63/45	70/30	80/56	90/45	100/70	120/70	125/90	140/90	160/110	200/140	250/180
Sección Vástago D.	3,14	6,15	10,17	7,06	15,90	7,06	24,63	15,90	38,48	38,48	63,61	63,61	95,03	153,90	254,40
Sección Anular	4,90	6,41	9,46	21,21	15,27	7,06	25,63	15,90	40,05	38,48	59,10	63,61	106,03	160,26	236,40
Conexiones Rosca GAS	1/4"	3/8"	3/8"	3/8"	1/2"	3/8"	1/2"	1/2"	3/4"	1/2"	3/4"	3/4"	1"	1 1/4"	1 1/4"

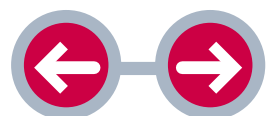



# CILINDROS HIDRAULICOS HYDRAULIC CYLINDERS

**CS**  
ISO 3320

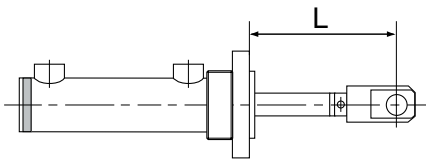

**AS**

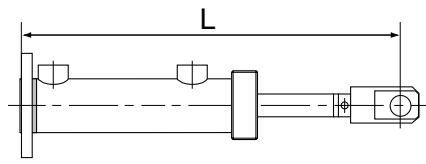

**BS**

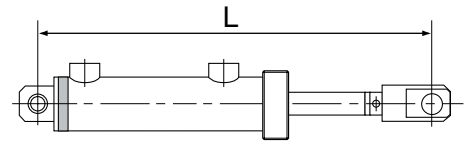

**DS**

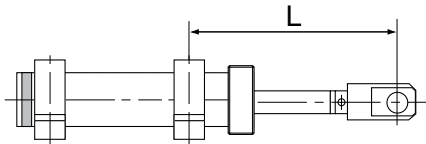

**ES**

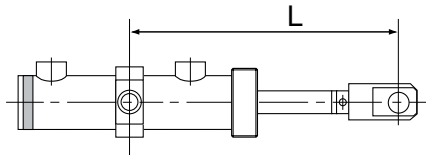

**FS**

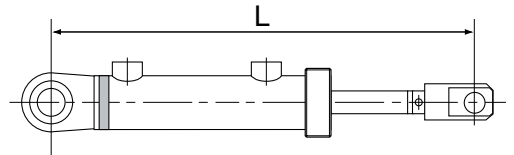

**GS**

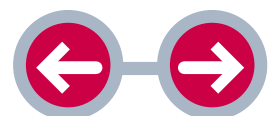
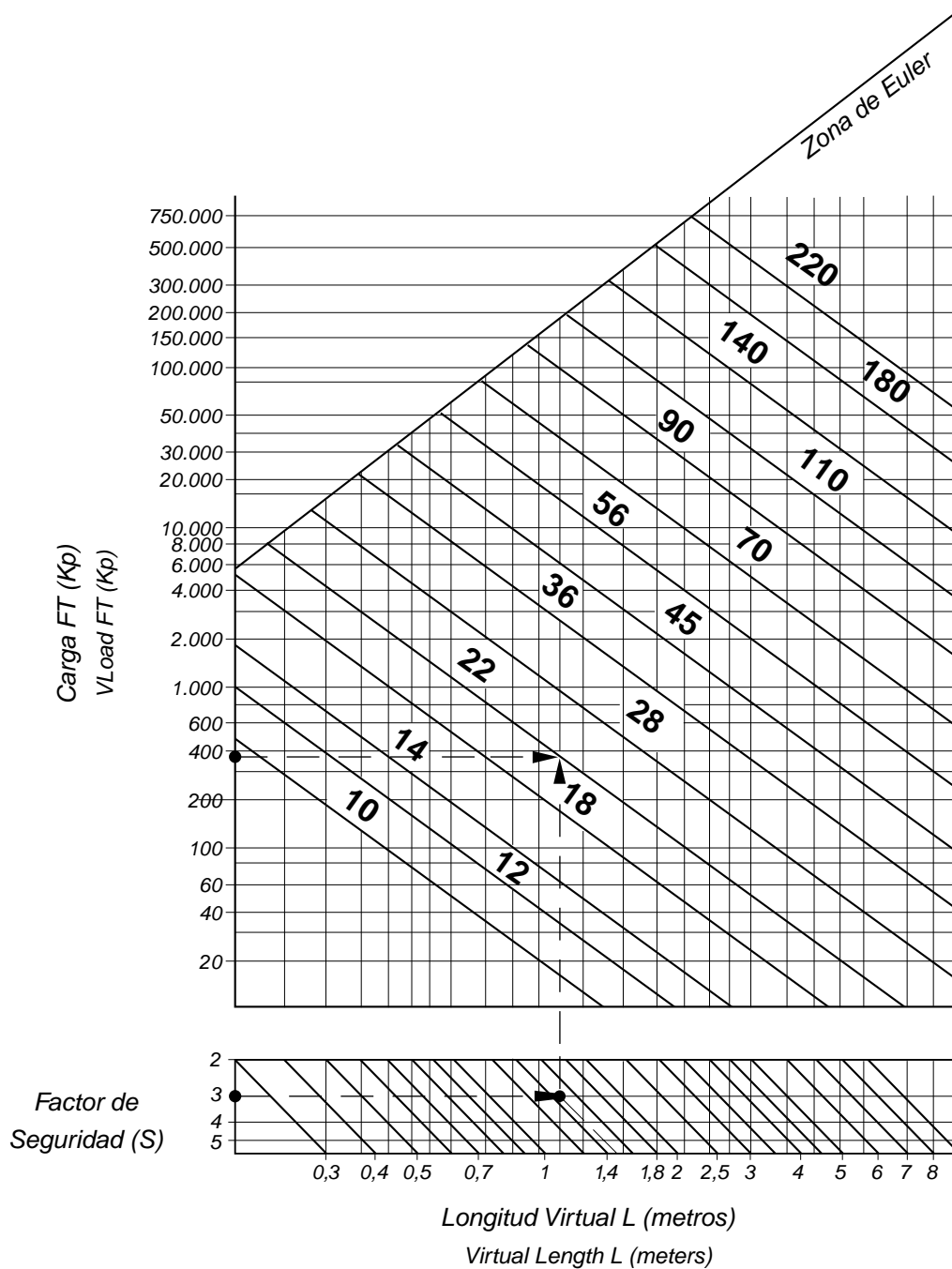



**• DESIGNACION CILINDROS REF.: CS •**

**CS - 050 / 036 / 036 - 300 - XS - M - 01**

**TIPO**

**PISTON**

**VASTAGO**

**DOBLE VASTAGO**

**LONGITUD CARRERA**

**SERIE**

**JUNTAS**

M - Estandar

T - Vitón

**FIJACION**

XS - Cilindro base

AS - Brida delantera

BS - Brida Trasera

DS - Charnela trasera

ES - Fijación patas

FS - Fijación Muñones

GS - Charnela Rótula

**• MODEL CODE FOR CS CYLINDERS •**

**CS - 050 / 036 / 036 - 300 - XS - M - 01**

**TYPE**

**BORE Ø**

**ROD Ø**

**ROD Ø (if requiered)**

**STROKE**

**SERIES**

**SEALS**

M - Standard

T - Vitón

**ATTACHMENTS**

XS - Bore Cylinder

AS - Front Flange Mounting

BS - Rear Flange Mounting

DS - Eye Mounting

ES - Foot Mounting

FS - Head Trunnion Mounting

GS - Espherical Eye Mounting

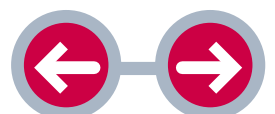

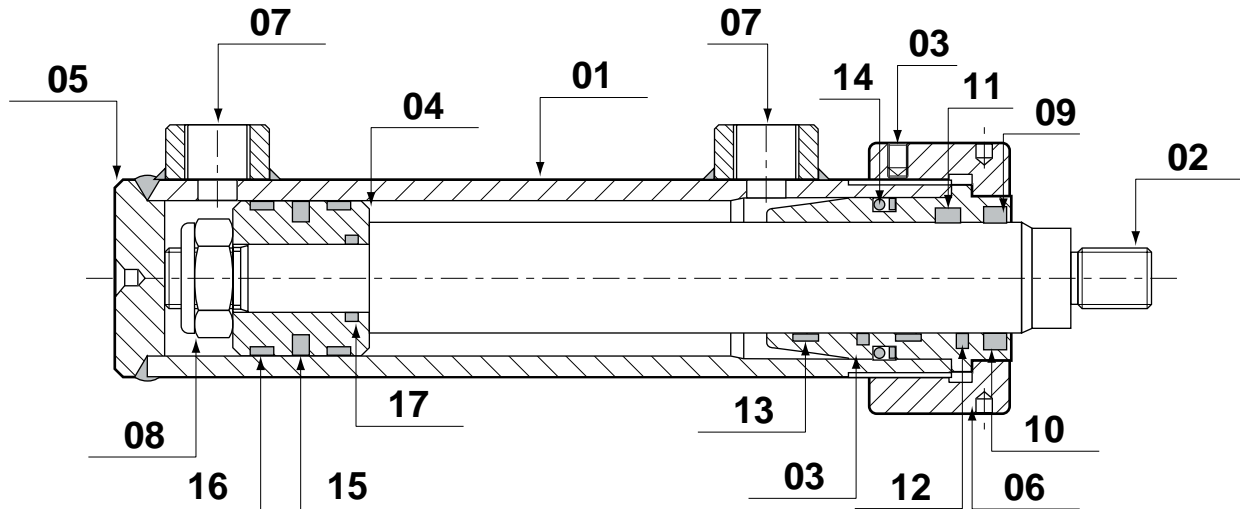

• DESCRIPCION •	
01	Camisa
02	Vástago
03	Guía vástago
04	Pistón portajuntas
05	Tapa trasera
06	Tuerca fijación guía
07	Mechón entradas aceite
08	Tuerca fijación pistón
09	Rascador vástago (ISO 6195/A)
10	Rascador vástago (ISO 6195/B)
11	Junta vástago (ISO 5597/1)
12	Junta vástago (ISO 7425/2)
13	Anillo guía vástago
14	Junta tórica camisa
15	Junta pistón (ISO 7425/1)
16	Anillo guía pistón
17	Junta tórica pistón

• DESCRIPTION •	
01	Cylinder housing
02	Rod
03	Rod guide rings
04	Piston
05	Rear cylinder head
06	Nut guide
07	Raccord of fluid inlet
08	Nut piston
09	Wiper (ISO 6195/A)
10	Wiper (ISO 6195/B)
11	Rod seal (ISO 5597/1)
12	Rod seal (ISO 7425/A)
13	Low friction seals
14	O-Ring seal+Antiextrusion seal
15	Piston seal (ISO 7425/1)
16	Low-friction seals
17	O-Ring seal

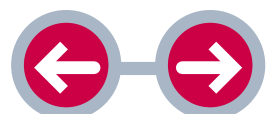



• TIPO - TYPE: **XS** •  
**Fijación base - Basical attachment**

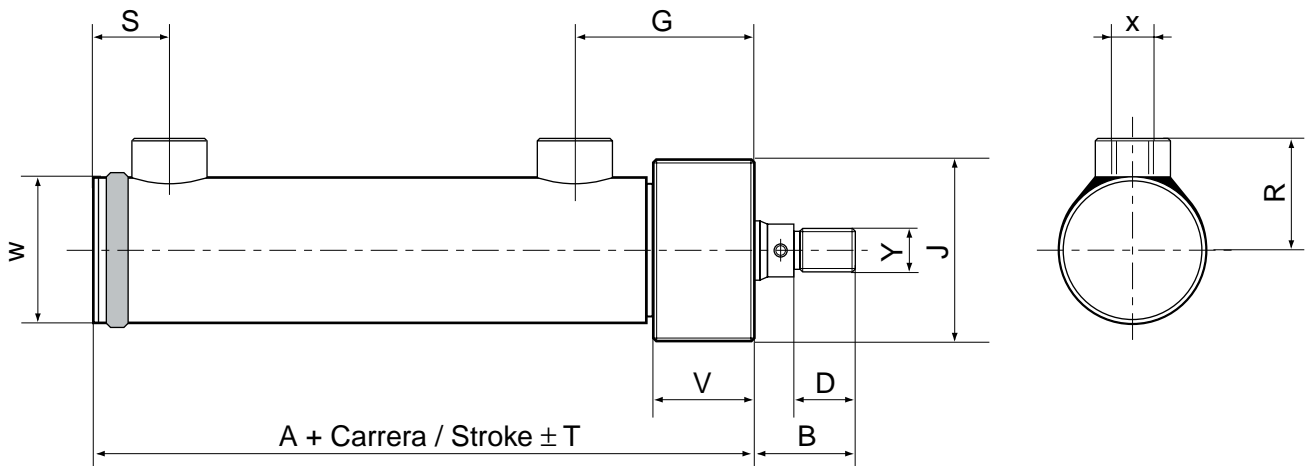

• EJECUCIÓN BASE • - • BORE CYLINDER •

TIPO CS	X	Y	A	B	D	G	J	R	S	T	V	W
CS-032	016 1/4" G.	12 x 125	106	30	16	50	52	35	26	2	32	42
CS-040	022 028 3/8" G.	16 x 150	126	35	20	62	62	41	25	2	40	50
CS-050	028 036 3/8" G.	20 x 150	136	41	25	64	74	46	29	2	41	60
CS-063	036 045 1/2" G.	27 x 2	149	48	32	64	89	54	35	2	39	75
CS-080	045 056 1/2" G.	33 x 2	168	59	40	74	112	65	40	2	46	95
CS-100	056 070 3/4" G.	42 x 2	189	70	50	84	135	76	45	3	52	115
CS-125	070 090 3/4" G.	52 x 2	203	80	55	88	170	91	57	3	53	145
CS-160	090 110 1" G.	68 x 3	255	100	70	112	218	116	72	3	67	185
CS-200	110 140 1 1/4" G.	90 x 3	297	125	90	127	272	138	90	3	80	230
CS-250	140 180 1 1/4" G.	110 x 3	338	150	110	155	335	172	103	4	105	298

CILCOIL, S.A. - se reserva el derecho de modificar: Técnica, material, cotas y formas sin previo aviso.

CILCOIL, S.A. - reserves the rights to modify: Techniques, materials, dimensions and shapes without prior notice.

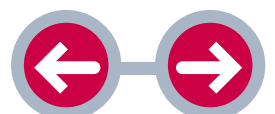



• **TIPO - TYPE: DS** •  
**Charnela macho - Eye mounting**

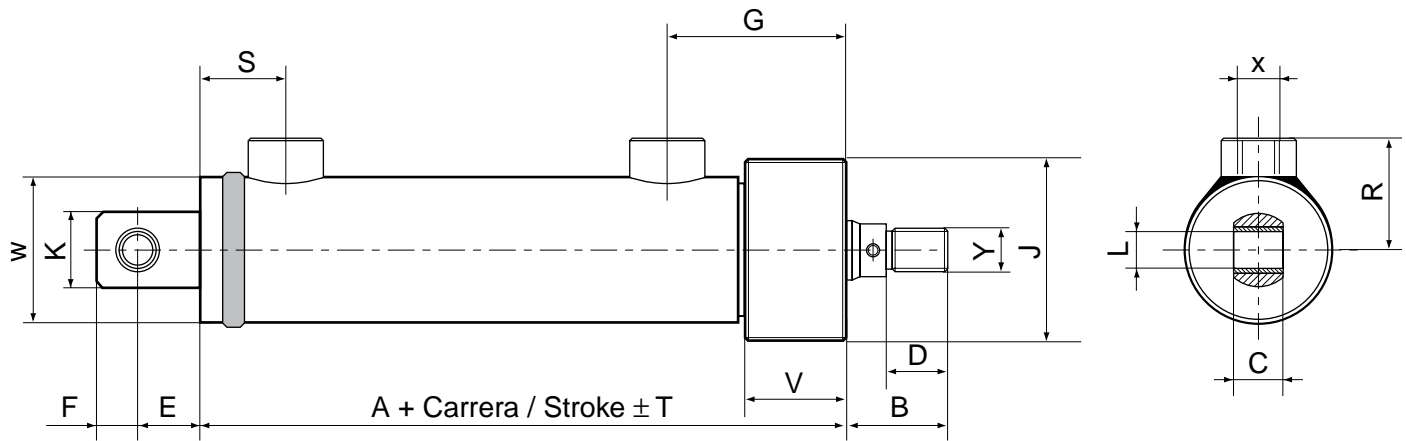

TIPO CS	X	Y	A	B	C	D	E	F	G	J	K	L	R	S	T	V	W	
CS-032	$\frac{016}{016}$	1/4" G.	12x125	106	30	16	16	20	13	50	52	26	12	35	26	2	32	42
CS-040	$\frac{022}{028}$	3/8" G.	16x150	126	35	20	20	25	16	62	62	32	16	41	25	2	40	50
CS-050	$\frac{028}{036}$	3/8" G.	20x150	136	41	25	25	28	20	64	74	40	20	46	29	2	41	60
CS-063	$\frac{036}{045}$	1/2" G.	27 x 2	149	48	32	32	32	25	64	89	50	25	54	35	2	39	75
CS-080	$\frac{045}{056}$	1/2" G.	33 x 2	168	59	40	40	45	32	74	112	64	32	65	40	2	46	95
CS-100	$\frac{056}{070}$	3/4" G.	42 x 2	189	70	50	50	55	40	84	135	80	40	76	45	3	52	115
CS-125	$\frac{070}{090}$	3/4" G.	52 x 2	203	80	60	55	65	50	88	170	100	50	91	57	3	53	145
CS-160	$\frac{090}{110}$	1" G.	68 x 3	255	100	80	70	75	63	112	218	126	63	116	72	3	67	185
CS-200	$\frac{110}{140}$	1 1/4" G.	90 x 3	297	125	100	90	95	80	127	272	160	80	138	90	3	80	230
CS-250	$\frac{140}{180}$	1 1/4" G.	110 x 3	338	150	120	110	130	100	155	335	200	100	172	103	4	105	298

CILCOIL, S.A. - se reserva el derecho de modificar: Técnica, material, cotas y formas sin previo aviso.

CILCOIL, S.A. - reserves the rights to modify: Techniques, materials, dimensions and shapes without prior notice.

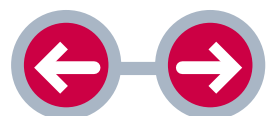





• **TIPO - TYPE: AS** •  
**Brida delantera - Front flange mounting**

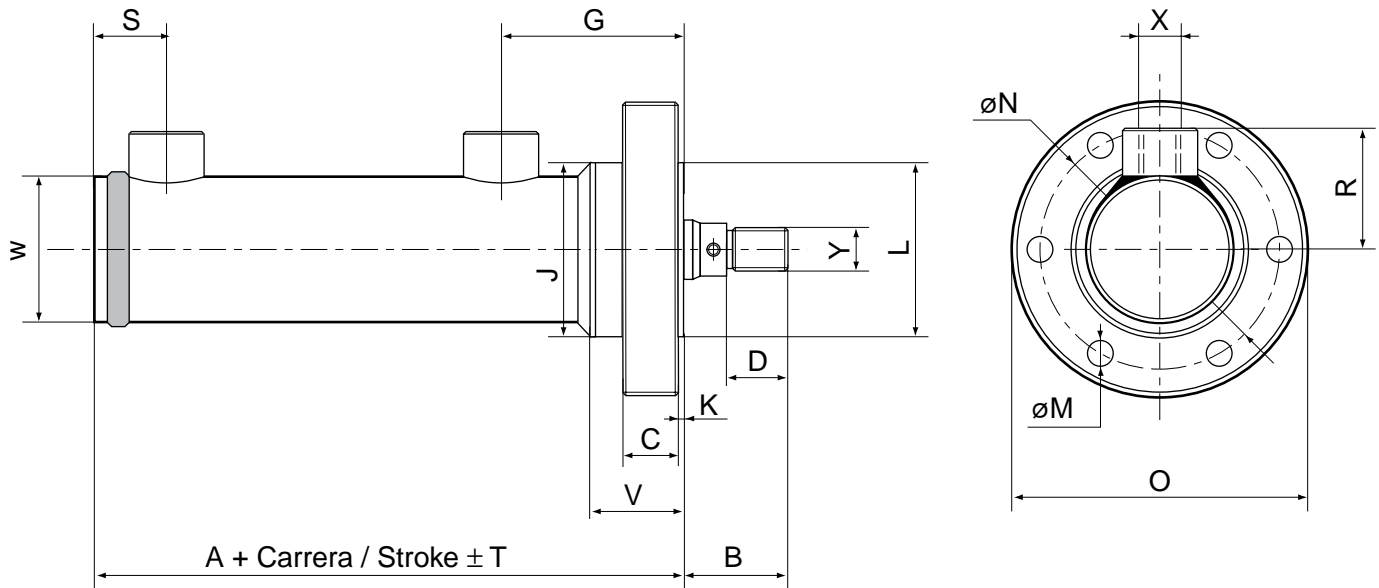

Nota: El cilindro serie: CS-250 lleva 12 taladros equidistantes (M) en vez de 6.

Note: The cylinder series: CS-250 carries 12 equidistant drills (M) instead of 6.

TIPO CS	X	Y	A	B	C	D	G	J	K	L	M	N	O	R	S	T	V	W
<b>CS-032</b> 016	1/4" G.	12 x 125	106	30	15	16	48	52	2	52	7	67	80	35	26	2	32	42
<b>CS-040</b> 022 028	3/8" G.	16 x 150	126	35	17	20	60	62	2	60	9	82	100	41	25	2	40	50
<b>CS-050</b> 028 036	3/8" G.	20 x 150	136	41	20	25	62	74	2	75	11	103	125	46	29	2	41	60
<b>CS-063</b> 036 045	1/2" G.	27 x 2	149	48	24	32	62	89	2	90	13	120	145	54	35	2	39	75
<b>CS-080</b> 045 056	1/2" G.	33 x 2	168	59	28	40	72	112	2	110	15	142	170	65	40	2	46	95
<b>CS-100</b> 056 070	3/4" G.	42 x 2	189	70	34	50	81	135	3	135	17	170	202	76	45	3	52	115
<b>CS-125</b> 070 090	3/4" G.	52 x 2	203	80	40	55	85	170	3	168	21	210	250	91	57	3	53	145
<b>CS-160</b> 090 110	1" G.	68 x 3	255	100	54	70	109	218	3	215	29	270	320	116	72	3	67	185
<b>CS-200</b> 110 140	1 1/4" G.	90 x 3	297	125	65	90	124	272	3	270	32	330	385	138	90	3	80	230
<b>CS-250</b> 140 180	1 1/4" G.	110 x 3	338	150	65	110	150	335	5	330	29	390	440	172	103	4	105	298

CILCOIL, S.A. - se reserva el derecho de modificar: Técnica, material, cotas y formas sin previo aviso.

CILCOIL, S.A. - reserves the rights to modify: Techniques, materials, dimensions and shapes without prior notice.

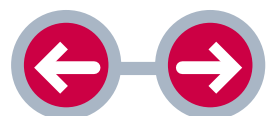



• TIPO - TYPE: **BS** •  
**Brida trasera - Rear flange mounting**

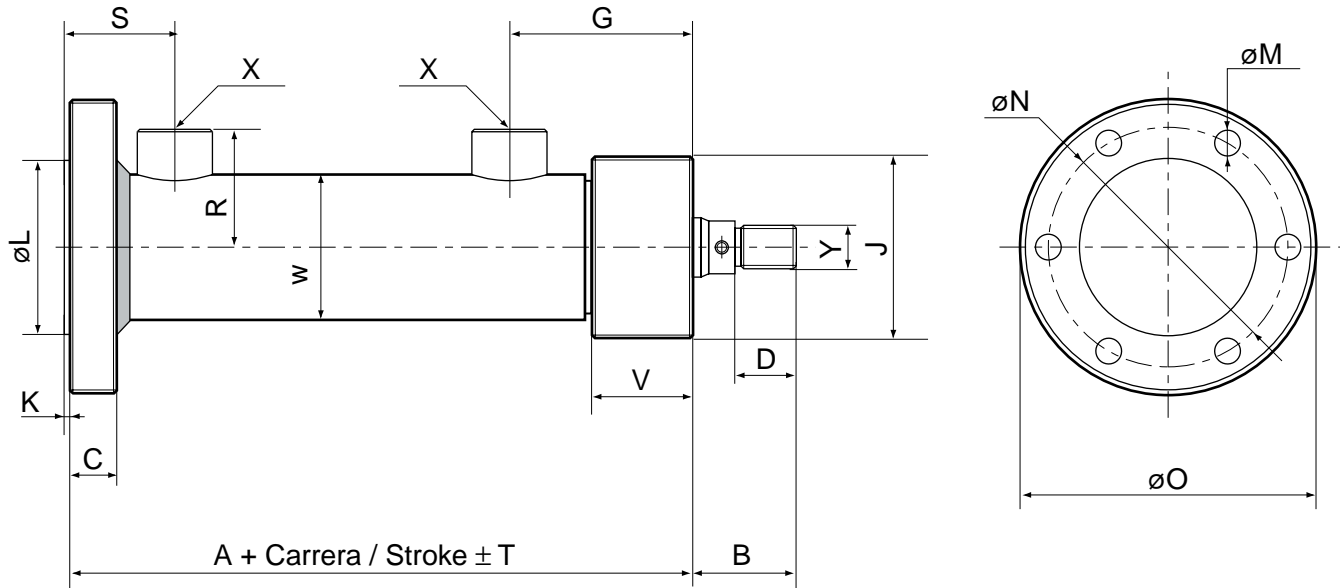

Nota: El cilindro serie: CS-250 lleva 12 taladros equidistantes (M) en vez de 6.

Note: The cylinder series: CS-250 carries 12 equidistant drills (M) instead of 6.

TIPO CS	X	Y	A	B	C	D	G	J	K	L	M	N	O	R	S	T	V	W
CS-032	$\frac{016}{028}$ 1/4" G.	12 x 125	108	30	10	16	50	52	2	52	7	67	80	35	30	2	32	42
CS-040	$\frac{022}{028}$ 3/8" G.	16 x 150	133	35	13	20	62	62	2	60	9	82	100	41	34	2	40	50
CS-050	$\frac{028}{036}$ 3/8" G.	20 x 150	142	41	15	25	64	74	2	75	11	103	125	46	37	2	41	60
CS-063	$\frac{036}{045}$ 1/2" G.	27 x 2	155	48	18	32	64	89	2	90	13	120	145	54	43	2	39	75
CS-080	$\frac{045}{056}$ 1/2" G.	33 x 2	178	59	22	40	74	112	2	110	15	142	170	65	52	2	46	95
CS-100	$\frac{056}{070}$ 3/4" G.	42 x 2	197	70	25	50	84	135	3	135	17	170	202	76	56	3	52	115
CS-125	$\frac{070}{090}$ 3/4" G.	52 x 2	211	80	30	55	88	170	3	168	21	210	250	91	68	3	53	145
CS-160	$\frac{090}{110}$ 1" G.	68 x 3	263	100	38	70	112	218	3	215	29	270	320	116	83	3	67	185
CS-200	$\frac{110}{140}$ 1 1/4" G.	90 x 3	306	125	42	90	127	272	3	270	32	330	385	138	102	3	80	230
CS-250	$\frac{140}{180}$ 1 1/4" G.	110 x 3	345	150	55	110	155	335	5	330	29	390	440	172	115	4	105	298

CILCOIL, S.A. - se reserva el derecho de modificar: Técnica, material, cotas y formas sin previo aviso.

CILCOIL, S.A. - reserves the rights to modify: Techniques, materials, dimensions and shapes without prior notice.

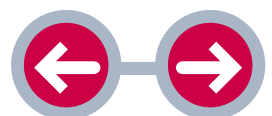



• TIPO - TYPE: **ES** .  
**Fijación por patas - Foot mounting**

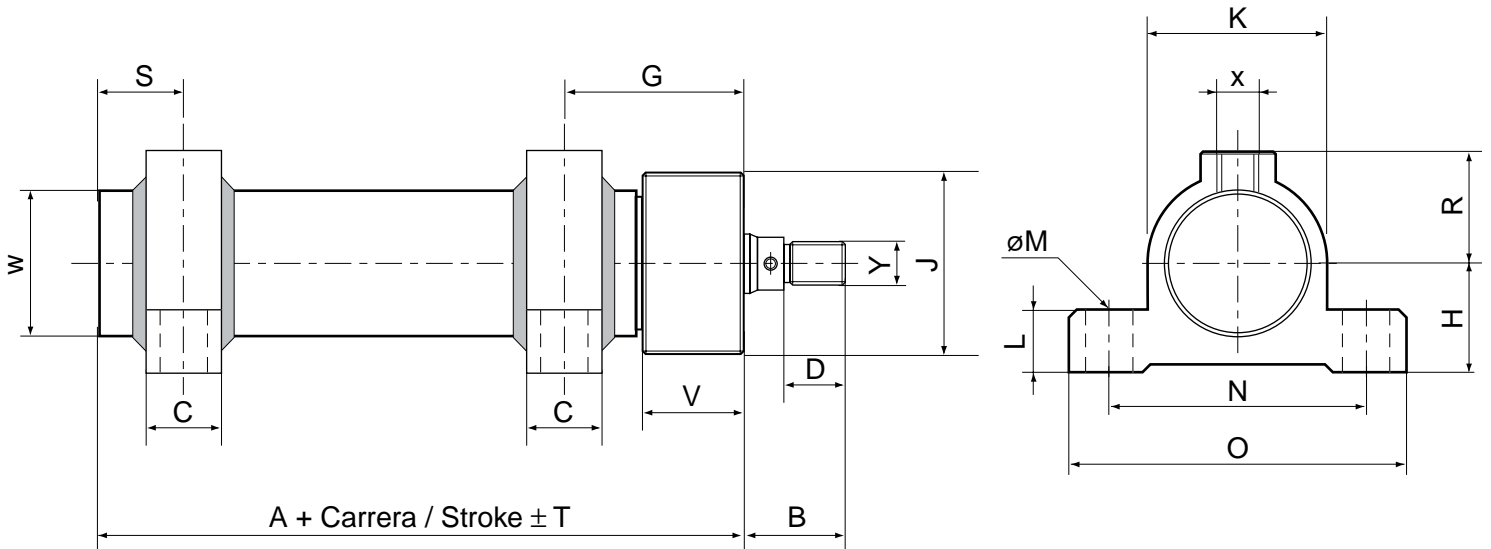

TIPO CS	X	Y	A	B	C	D	G	H	J	K	L	M	N	O	R	S	T	V	W
<b>CS-032</b>	016 1/4" G.	12x125	106	30	20	16	50	28	52	52	16	11	75	95	31	26	2	32	42
<b>CS-040</b>	022 028 3/8" G.	16x150	126	35	25	20	62	35	62	65	20	13	94	118	39	25	2	40	50
<b>CS-050</b>	028 036 3/8" G.	20x150	136	41	25	25	64	40	74	76	20	15	105	130	44	29	2	41	60
<b>CS-063</b>	036 045 1/2" G.	27 x 2	149	48	30	32	64	50	89	94	25	17	130	160	54	35	2	39	75
<b>CS-080</b>	045 056 1/2" G.	33x2	168	59	35	40	74	62	112	116	28	19	160	195	65	40	2	46	95
<b>CS-100</b>	056 070 3/4" G.	42 x 2	189	70	40	50	84	73	135	140	32	23	185	225	77	45	3	52	115
<b>CS-125</b>	070 090 3/4" G.	52 x 2	203	80	44	55	88	88	170	170	36	25	220	265	90	57	3	53	145
<b>CS-160</b>	090 110 1" G.	68 x 3	255	100	58	70	112	115	218	224	45	35	295	355	118	72	3	67	185
<b>CS-200</b>	110 140 1 1/4" G.	90 x 3	297	125	68	90	127	140	272	275	55	41	355	425	145	90	3	80	230
<b>CS-250</b>	140 180 1 1/4" G.	110 x 3	338	150	78	110	155	175	335	335	65	47	425	510	175	105	4	105	298

CILCOIL, S.A. - se reserva el derecho de modificar: Técnica, material, cotas y formas sin previo aviso.

CILCOIL, S.A. - reserves the rights to modify: Techniques, materials, dimensions and shapes without prior notice.

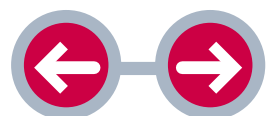



• **TIPO - TYPE: FS** •

**Muñones intermedios - Intermediate trunion mounting**

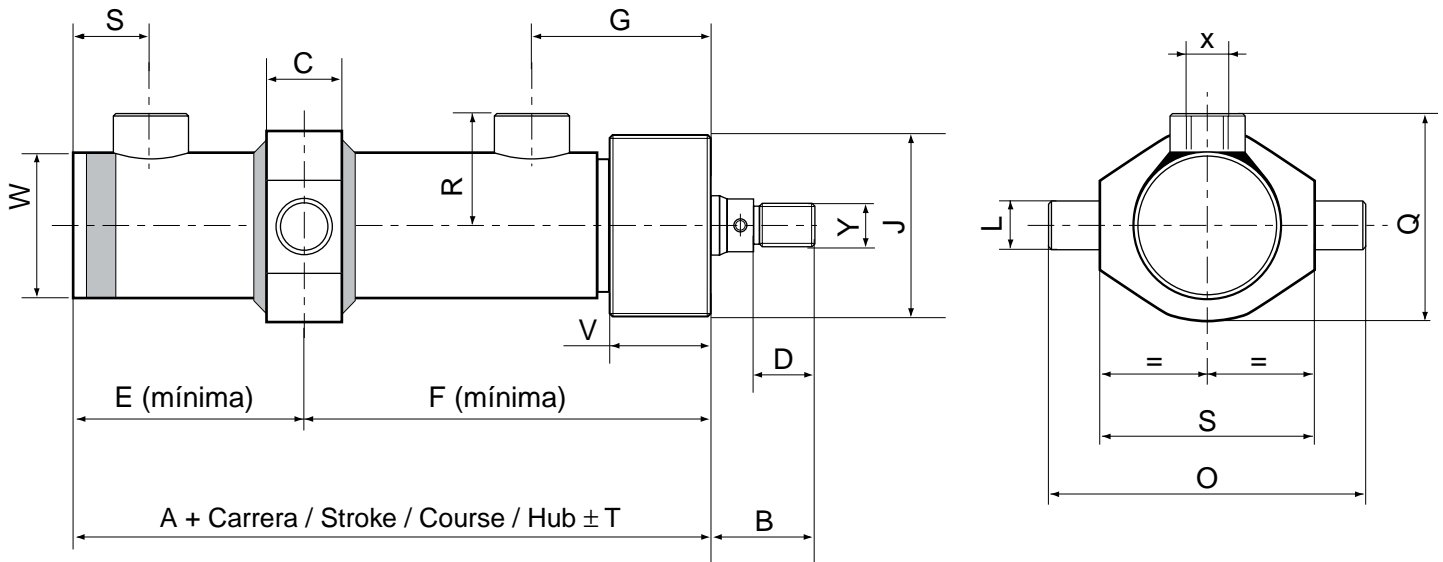

DIAMETRO CILINDRO CYLINDER DIAMETER		032	040	050	063	080	100	125	160	200	250									
Carrera mínima Min stroke		36	41	39	44	42	56	72	85	112	134									
TIPO CS	X	Y	A	B	C	D	E	F	G	J	K	L	O	Q	R	S	T	V	W	
<b>CS-032</b>	$\frac{016}{016}$	1/4" G.	12x125	106	30	20	16	59	83	50	52	56	16	80	54	35	26	2	32	42
<b>CS-040</b>	$\frac{022}{028}$	3/8" G.	16x150	126	35	24	20	63	100	62	62	70	20	102	65	41	25	2	40	50
<b>CS-050</b>	$\frac{028}{036}$	3/8" G.	20x150	136	41	30	25	70	105	64	74	85	25	125	80	46	29	2	41	60
<b>CS-063</b>	$\frac{036}{045}$	1/2" G.	27 x 2	149	48	36	32	82	111	64	89	105	32	155	95	54	35	2	39	75
<b>CS-080</b>	$\frac{045}{056}$	1/2" G.	33 x 2	168	59	36	40	88	122	74	112	125	32	175	120	65	40	2	46	95
<b>CS-100</b>	$\frac{056}{070}$	3/4" G.	42 x 2	189	70	45	50	103	142	84	135	156	40	220	145	76	45	3	52	115
<b>CS-125</b>	$\frac{070}{090}$	3/4" G.	52 x 2	203	80	55	55	118	150	88	170	190	50	270	174	91	57	3	53	145
<b>CS-160</b>	$\frac{090}{110}$	1" G.	68 x 3	255	100	70	70	146	187	112	218	250	63	350	236	116	72	3	67	185
<b>CS-200</b>	$\frac{110}{140}$	1 1/4" G.	90 x 3	297	125	90	90	178	223	127	272	300	80	426	290	138	90	3	80	230
<b>CS-250</b>	$\frac{140}{180}$	1 1/4" G.	110 x 3	338	150	110	110	210	257	155	335	360	100	520	345	172	103	4	105	298

CILCOIL, S.A. - se reserva el derecho de modificar: Técnica, material, cotas y formas sin previo aviso.

CILCOIL, S.A. - reserves the rights to modify: Techniques, materials, dimensions and shapes without prior notice.

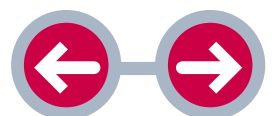



• **TIPO - TYPE: GS .**

**Charnela rótula trasera - Espherical eye mounting**

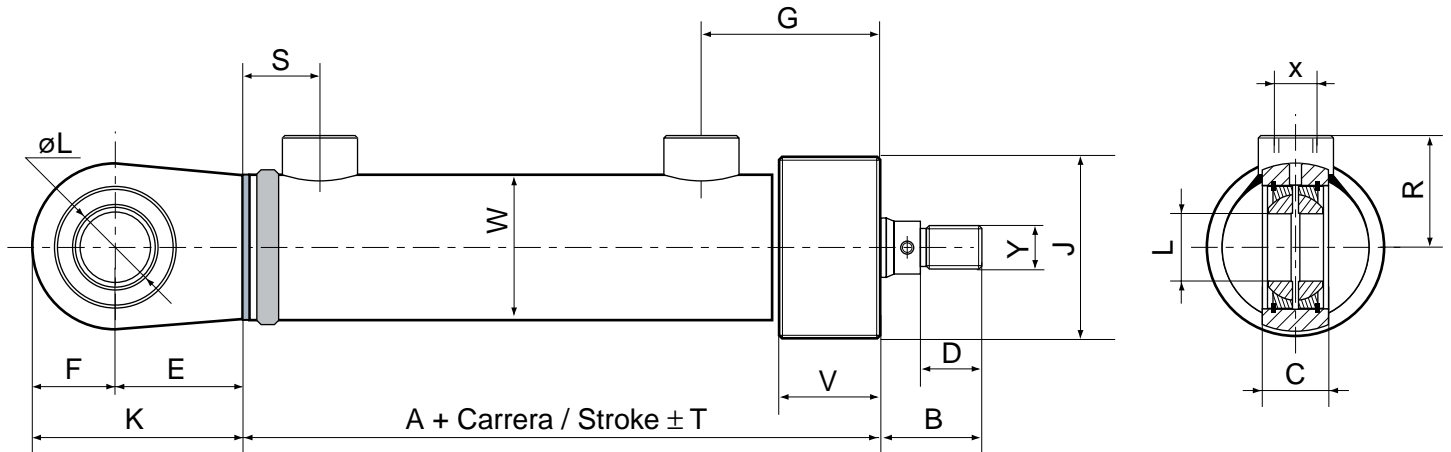

TIPO CS		X	Y	A	B	C	D	E	F	G	J	K	L	R	S	T	V	W
<b>CS-032</b>	016	1/4" G.	12 x 125	106	30	19	16	38	25	50	52	63	20	35	26	2	32	42
<b>CS-040</b>	022 028	3/8" G.	16 x 150	126	35	23	20	45	28	62	62	73	25	41	25	2	40	50
<b>CS-050</b>	028 036	3/8" G.	20 x 150	136	41	28	25	51	33	64	74	84	30	46	29	2	41	60
<b>CS-063</b>	036 045	1/2" G.	27 x 2	149	48	30	32	61	42	64	89	103	35	54	35	2	39	75
<b>CS-080</b>	045 056	1/2" G.	33 x 2	168	59	35	40	69	50	74	112	119	40	65	40	2	46	95
<b>CS-100</b>	056 070	3/4" G.	42 x 2	189	70	40	50	88	62	84	135	150	50	76	45	3	52	115
<b>CS-125</b>	070 090	3/4" G.	52 x 2	203	80	50	55	100	70	88	170	170	60	91	57	3	53	145
<b>CS-160</b>	090 110	1" G.	68 x 3	255	100	60	70	141	90	112	218	231	80	118	72	3	67	185
<b>CS-200</b>	110 140	1 1/4" G.	90 x 3	297	125	70	90	145	125	127	272	270	100	138	90	3	80	230
<b>CS-250</b>	140 180	1 1/4" G.	110 x 3	338	150	80	110	165	148	155	335	313	110	172	103	4	105	298

CILCOIL, S.A. - se reserva el derecho de modificar: Técnica, material, cotas y formas sin previo aviso.

CILCOIL, S.A. - reserves the rights to modify: Techniques, materials, dimensions and shapes without prior notice.

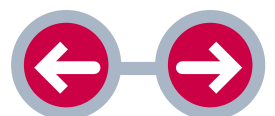



**• TIPO - TYPE: XD •**  
**Cilindro de doble vástago - Double rod cylinder**

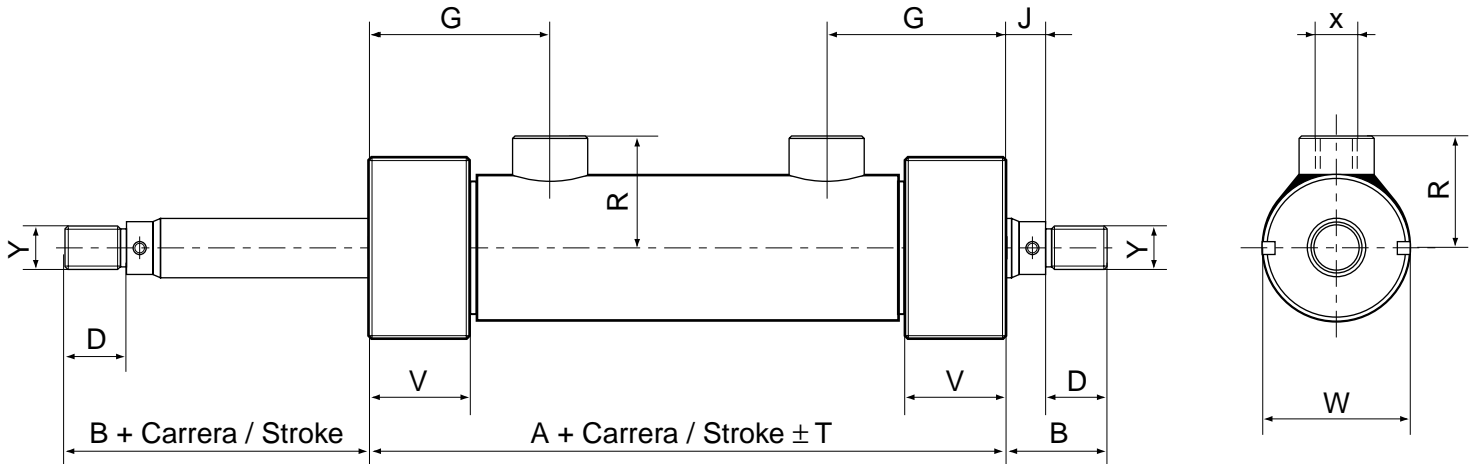

TIPO CG	X	Y	A	B	D	G	J	R	T	V	W
<b>CG-032</b> <sub>016</sub>	1/4" G.	12 x 125	129	30	16	50	14	31	2	10	42
<b>CG-040</b> <sub>022 028</sub>	3/8" G.	16 x 150	159	35	20	62	15	39	2	15	50
<b>CG-050</b> <sub>028 036</sub>	3/8" G.	20 x 150	168	41	25	64	16	44	2	15	60
<b>CG-063</b> <sub>036 045</sub>	1/2" G.	27 x 2	170	48	32	64	16	54	2	15	75
<b>CG-080</b> <sub>045 056</sub>	1/2" G.	33 x 2	190	59	40	74	19	65	2	15	95
<b>CG-100</b> <sub>056 070</sub>	3/4" G.	42 x 2	212	70	50	84	20	77	3	16	115
<b>CG-125</b> <sub>070 090</sub>	3/4" G.	52 x 2	222	80	55	88	25	92	3	20	145
<b>CG-160</b> <sub>090 110</sub>	1" G.	68 x 3	277	100	70	112	30	118	3	20	185
<b>CG-200</b> <sub>110 140</sub>	1 1/4" G.	90 x 3	318	125	90	127	35	145	3	25	230
<b>CG-250</b> <sub>140 180</sub>	1 1/4" G.	110 x 3	375	150	110	155	40	174	4	30	298

CILCOIL, S.A. - se reserva el derecho de modificar: Técnica, material, cotas y formas sin previo aviso.

CILCOIL, S.A. - reserves the rights to modify: Techniques, materials, dimensions and shapes without prior notice.

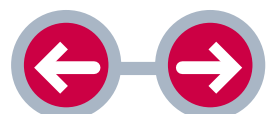



**• TIPO - TYPE: AD •**

**Cilindro de doble vástago - Double rod cylinder**

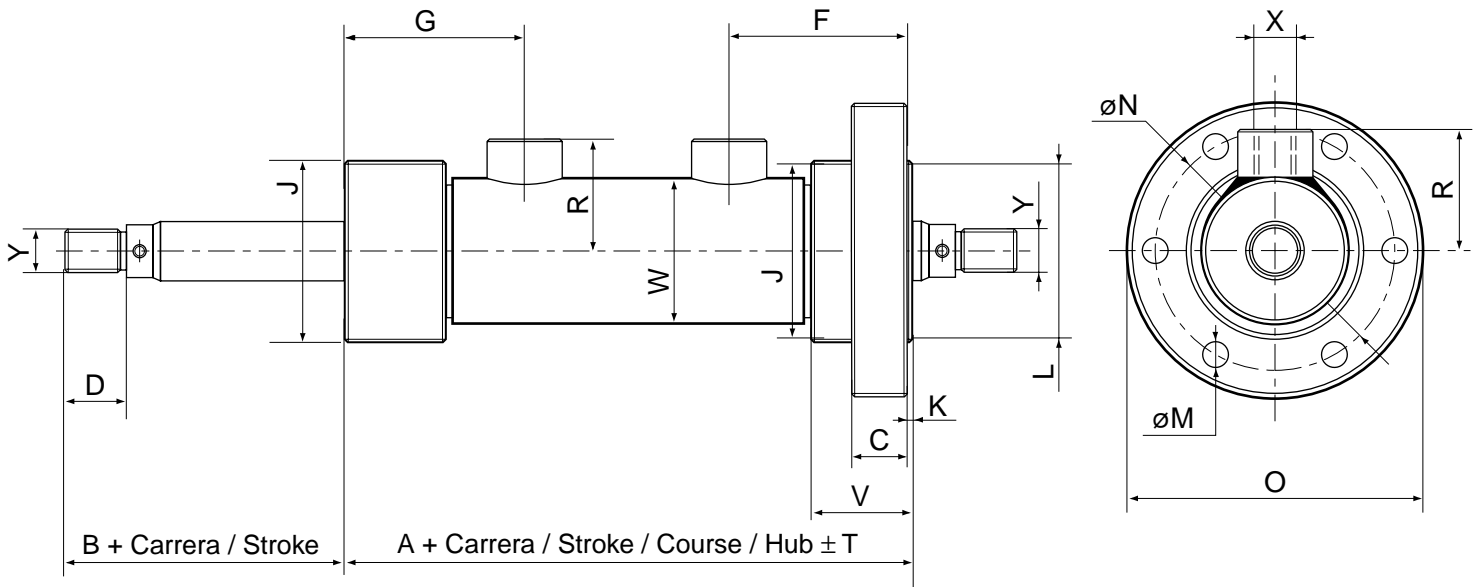

Nota: El cilindro serie: CS-250 lleva 12 taladros equidistantes (M) en vez de 6.  
Note: The cylinder series: CS-250 carries 12 equidistant drills (M) instead of 6.

TIPO CS	X	Y	A	B	C	D	F	G	J	K	L	M	N	O	R	T	V	W
<b>CS-032</b>	016 1/4" G.	12 x 125	129	30	15	16	48	50	52	2	52	7	67	80	35	2	32	42
<b>CS-040</b>	022 028 3/8" G.	16 x 150	159	35	17	20	60	62	62	2	60	9	82	100	41	2	40	50
<b>CS-050</b>	028 036 3/8" G.	20 x 150	168	41	20	25	62	64	74	2	75	11	103	125	46	2	41	60
<b>CS-063</b>	036 045 1/2" G.	27 x 2	170	48	24	32	62	64	89	2	90	13	120	145	54	2	39	75
<b>CS-080</b>	045 056 1/2" G.	33 x 2	190	59	28	40	72	74	112	2	110	15	142	170	65	2	46	95
<b>CS-100</b>	056 070 3/4" G.	42 x 2	212	70	34	50	81	84	135	3	135	17	170	202	76	3	52	115
<b>CS-125</b>	070 090 3/4" G.	52 x 2	222	80	40	55	85	88	170	3	168	21	210	250	91	3	53	145
<b>CS-160</b>	090 110 1" G.	68 x 3	277	100	54	70	109	112	218	3	215	29	270	320	116	3	67	185
<b>CS-200</b>	110 140 1 1/4" G.	90 x 3	318	125	65	90	124	127	272	3	270	32	330	385	138	3	80	230
<b>CS-250</b>	140 180 1 1/4" G.	110 x 3	375	150	65	110	150	155	335	5	330	29	390	440	172	4	105	298

CILCOIL, S.A. - se reserva el derecho de modificar: Técnica, material, cotas y formas sin previo aviso.

CILCOIL, S.A. - reserves the rights to modify: Techniques, materials, dimensions and shapes without prior notice.

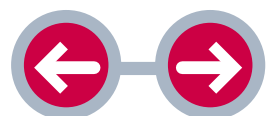



• TIPO - TYPE: **ED** •

**Cilindro de doble vástago - Double rod cylinder**

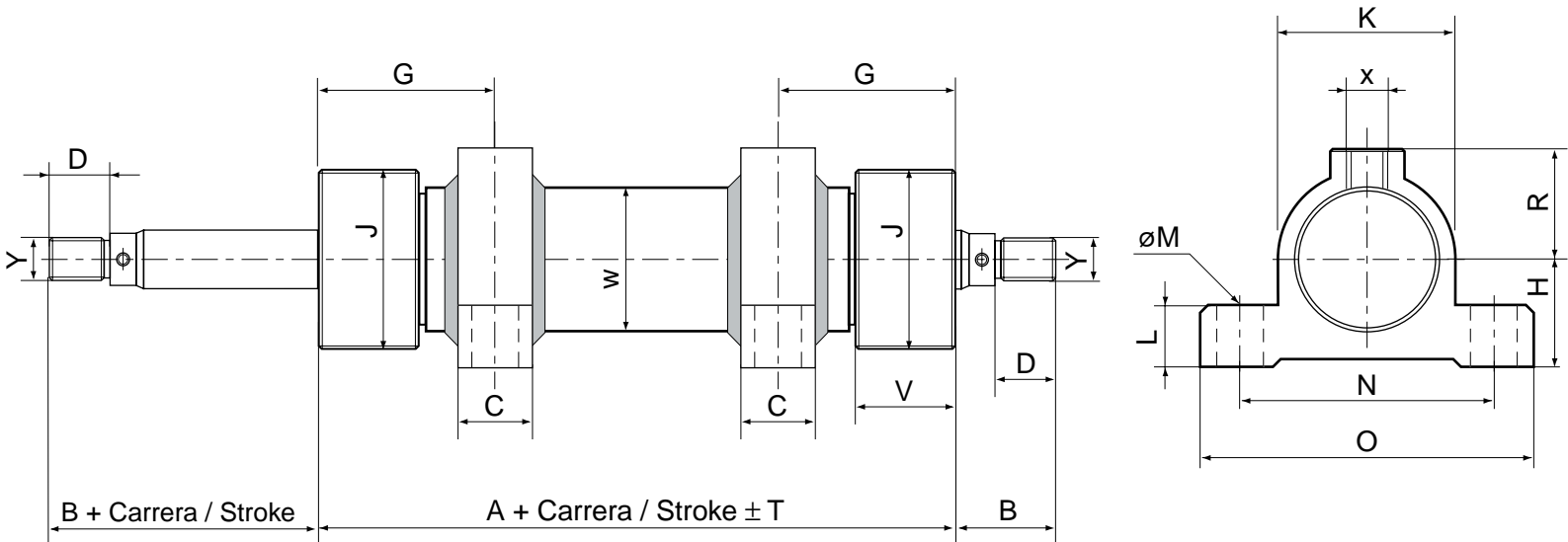

TIPO CS	X	Y	A	B	C	D	G	H	J	K	L	M	N	O	R	T	V	W
<b>CS-032</b> / 016	1/4" G.	12 x 125	129	30	20	16	50	28	52	52	16	11	75	95	31	2	32	42
<b>CS-040</b> / 022 / 028	3/8" G.	16 x 150	159	35	25	20	62	35	62	65	20	13	94	118	39	2	40	50
<b>CS-050</b> / 028 / 036	3/8" G.	20 x 150	168	41	25	25	64	40	74	76	20	15	105	130	44	2	41	60
<b>CS-063</b> / 036 / 045	1/2" G.	27 x 2	170	48	30	32	64	50	89	94	25	17	130	160	54	2	39	75
<b>CS-080</b> / 045 / 056	1/2" G.	33 x 2	190	59	35	40	74	62	112	116	28	19	160	195	65	2	46	95
<b>CS-100</b> / 056 / 070	3/4" G.	42 x 2	212	70	40	50	84	73	135	140	32	23	185	225	77	3	52	115
<b>CS-125</b> / 070 / 090	3/4" G.	52 x 2	222	80	44	55	88	88	170	170	36	25	220	265	90	3	53	145
<b>CS-160</b> / 090 / 110	1" G.	68 x 3	277	100	58	70	112	115	218	224	45	35	295	355	118	3	67	185
<b>CS-200</b> / 110 / 140	1 1/4" G.	90 x 3	318	125	68	90	127	140	272	275	55	41	355	425	145	3	80	230
<b>CS-250</b> / 140 / 180	1 1/4" G.	110 x 3	375	150	78	110	155	175	335	335	65	47	425	510	175	4	105	298

CILCOIL, S.A. - se reserva el derecho de modificar: Técnica, material, cotas y formas sin previo aviso.

CILCOIL, S.A. - reserves the rights to modify: Techniques, materials, dimensions and shapes without prior notice.

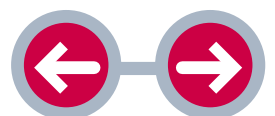





• **TIPO - TYPE: FD** •

**Muñones intermedios - Intermediate trunion mounting**  
**Cilindro de doble vástago - Double rod cylinder**

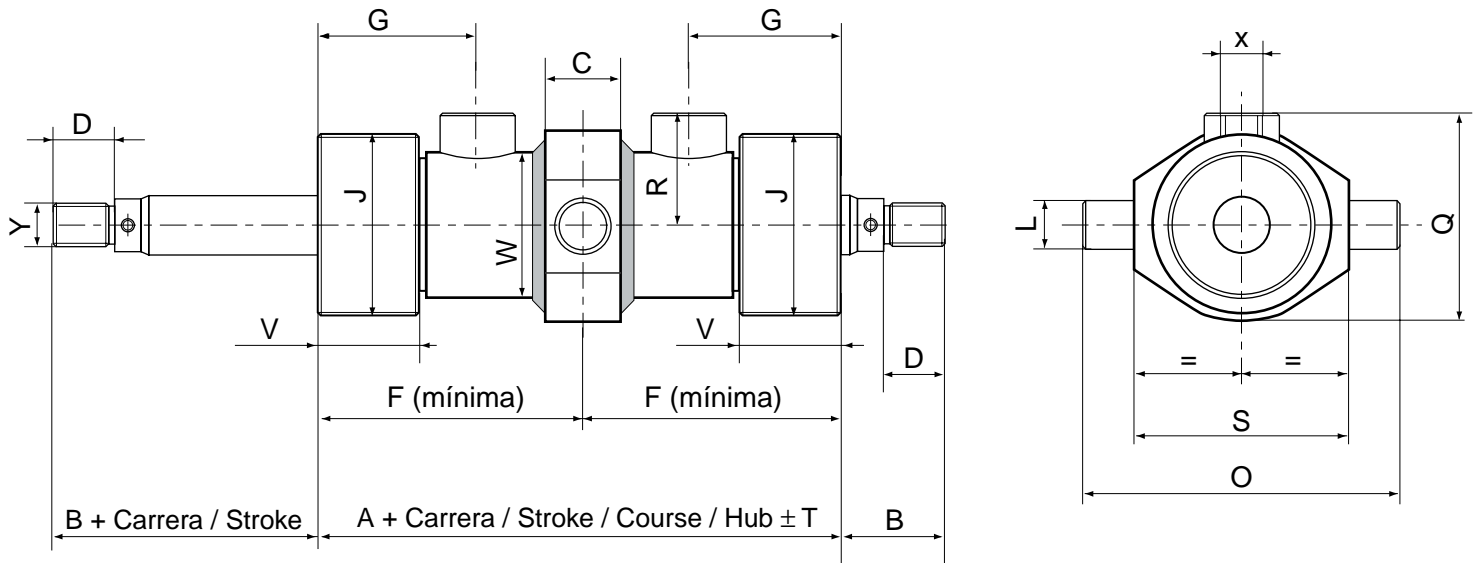

<b>DIAMETRO CILINDRO</b>		032	040	050	063	080	100	125	160	200	250							
<b>Carrera mínima</b>		37	41	52	52	54	72	84	103	128	149							
<b>TIPO CS</b>	<b>X</b>	<b>Y</b>	<b>A</b>	<b>B</b>	<b>C</b>	<b>D</b>	<b>F</b>	<b>G</b>	<b>J</b>	<b>K</b>	<b>L</b>	<b>O</b>	<b>Q</b>	<b>R</b>	<b>T</b>	<b>V</b>	<b>W</b>	
<b>CS-032</b>	016	1/4" G.	12x125	129	30	20	16	83	50	52	56	16	80	54	35	2	32	42
<b>CS-040</b>	022 028	3/8" G.	16x150	159	35	24	20	100	62	62	70	20	102	65	41	2	40	50
<b>CS-050</b>	028 036	3/8" G.	20x150	168	41	30	25	105	64	74	85	25	125	80	46	2	41	60
<b>CS-063</b>	036 045	1/2" G.	27x2	170	48	36	32	111	64	89	105	32	155	95	54	2	39	75
<b>CS-080</b>	045 056	1/2" G.	33x2	190	59	36	40	122	74	112	125	32	175	120	65	2	46	95
<b>CS-100</b>	056 070	3/4" G.	42x2	212	70	45	50	142	84	135	156	40	220	145	76	3	52	115
<b>CS-125</b>	070 090	3/4" G.	52x2	222	80	55	55	150	88	170	190	50	270	174	91	3	53	145
<b>CS-160</b>	090 110	1" G.	68x3	277	100	68	70	187	112	218	250	63	350	236	116	3	67	185
<b>CS-200</b>	110 140	1 1/4" G.	90x3	318	125	90	90	223	127	272	300	80	426	290	138	3	80	230
<b>CS-250</b>	140 180	1 1/4" G.	110x3	375	150	110	110	257	155	335	360	100	520	345	172	4	105	298

CILCOIL, S.A. - se reserva el derecho de modificar: Técnica, material, cotas y formas sin previo aviso.

CILCOIL, S.A. - reserves the rights to modify: Techniques, materials, dimensions and shapes without prior notice.

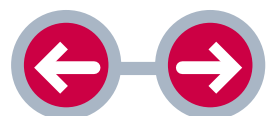



• **TIPO - TYPE: AM** •  
**Arrastrador macho - Plain rod eye**

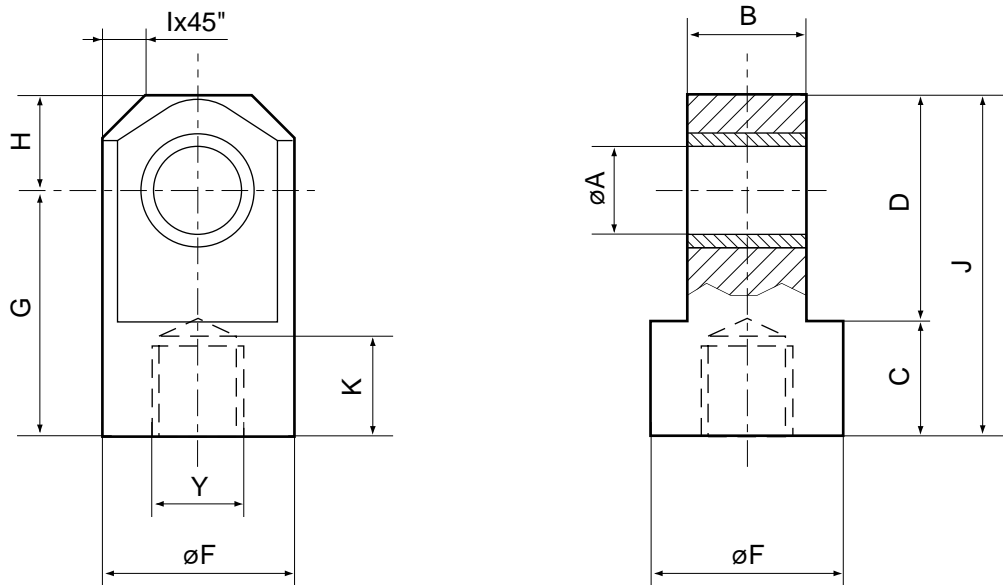

TIPO CS	Yø	A	B	C	D	K	F	G	H	I	J
CS-032	12 x 125	12	16	16	31	18	26	34	13	6	47
CS-040	16 x 150	16	20	24	41	22	32	49	16	8	65
CS-050	20 x 150	20	25	28	48	26	40	56	20	10	76
CS-063	27 x 2	25	32	35	57	33	50	67	25	15	92
CS-080	33 x 2	32	40	44	77	42	64	89	32	17	121
CS-100	42 x 2	40	50	54	95	52	80	109	40	20	149
CS-125	52 x 2	50	60	58	115	57	100	123	50	27	173
CS-160	68 x 3	63	80	75	138	72	126	150	63	35	213
CS-200	90 x 3	80	100	95	175	90	160	190	80	45	270
CS-250	110 x 3	100	120	115	230	112	200	245	100	55	345

CILCOIL, S.A. - se reserva el derecho de modificar: Técnica, material, cotas y formas sin previo aviso.

CILCOIL, S.A. - reserves the rights to modify: Techniques, materials, dimensions and shapes without prior notice.

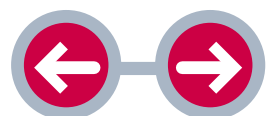



## ISO 8133

• **TIPO - TYPE: AH** •  
**Horquilla - Rod clevis**

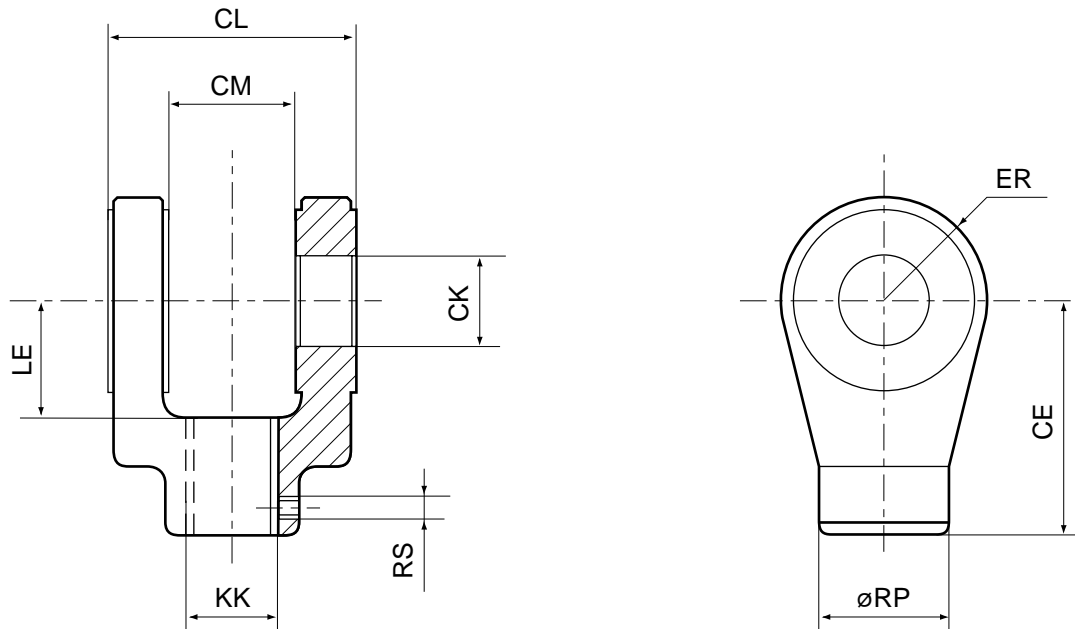

Los cilindros suministrados con "HORQUILLA HEMBRA" se adaptarán las roscas a los diámetros standard de las mismas. (INA, SKF, etc...).

TIPO AH	KK	CE	CK	CL	CM	ER	LE	RP	RS
AH-032	12 x 125	36	12	32	16	17	19	21	M5
AH-040	16 x 150	54	20	60	30	29	32	32	M6
AH-050	20 x 150	60	20	60	30	29	32	32	M6
AH-063	27 x 2	75	28	80	40	34	39	40	M6
AH-080	33 x 2	99	36	100	50	50	54	55	M8
AH-100	42 x 2	113	45	120	60	53	57	55	M8
AH-125	48 x 2	126	56	140	70	59	63	75	M8
AH-160	64 x 3	168	70	160	80	78	83	95	M12
AH-200	80 x 3	168	70	160	80	78	83	95	M12
AH-250	-	-	-	-	-	-	-	-	-

CILCOIL, S.A. - se reserva el derecho de modificar: Técnica, material, cotas y formas sin previo aviso.

CILCOIL, S.A. - reserves the rights to modify: Techniques, materials, dimensions and shapes without prior notice.

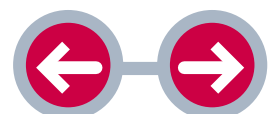



• TIPO - TYPE: **AR** •

**Cabeza de rótula - Rod eye with spherical bearing**

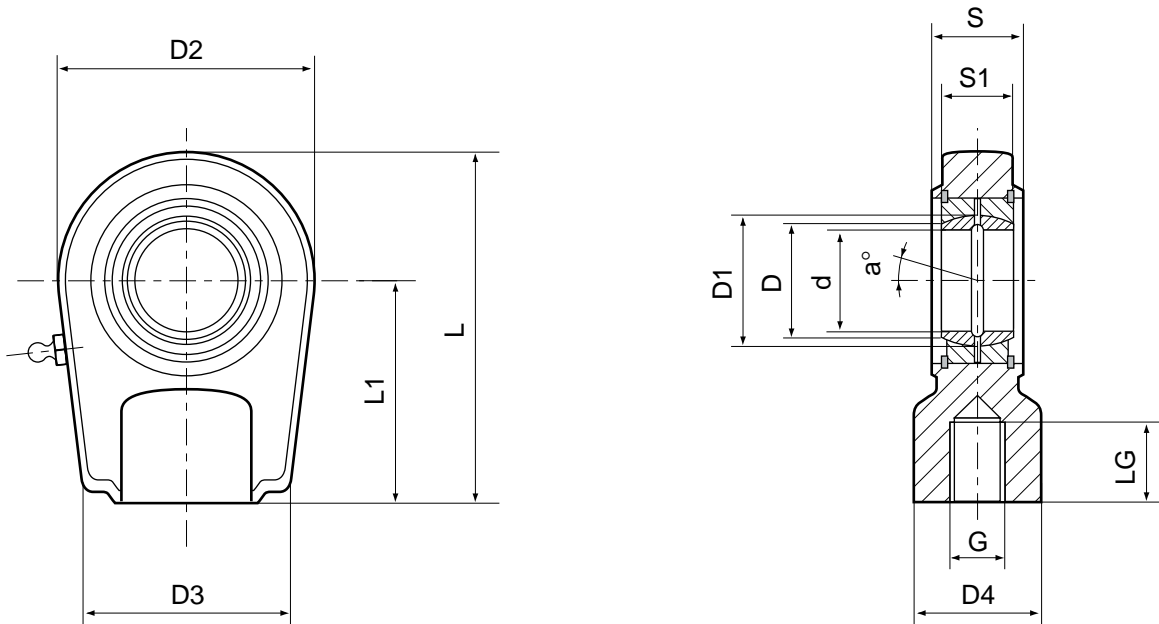

Los cilindros suministrados con "CHAPE ROTULA" se adaptarán las roscas a los diámetros standard de las mismas. (INA, SKF, etc...).

TIPO AR	G	d	D	D1	D2	D3	D4	S	S1	L	L1	LG	a°
AR-032	16 x 150	20	24	29	56	46	25	19	15	80	50	17	9
AR-040	16 x 150	25	29	35,5	56	46	25	23	19	80	50	17	7
AR-050	22 x 150	30	34	40,7	64	50	32	28	21	94	60	23	6
AR-063	28 x 150	35	39,5	47	78	66	40	30	23	112	70	29	6
AR-080	35 x 150	40	45	53	94	76	49	35	25	135	85	36	7
AR-100	45 x 150	50	56	66	116	90	61	40	32	168	105	46	6
AR-125	58 x 150	60	66,5	80	130	120	75	50	41	200	130	59	7
AR-160	80 x 2	80	89	105	177	160	105	60	50	265	170	81	6
AR-200	110 x 2	100	109,5	130	230	199	138	70	60	360	235	111	7
AR-250	120 x 3	110	121	140	265	225	152	80	60	408	265	125	6

CILCOIL, S.A. - se reserva el derecho de modificar: Técnica, material, cotas y formas sin previo aviso.

CILCOIL, S.A. - reserves the rights to modify: Techniques, materials, dimensions and shapes without prior notice.

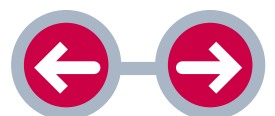



**DIN 24555 - ISO 8133.**

• **TIPO - TYPE: AI** •

**Cabeza de rótula - Rod eye with spherical bearing**

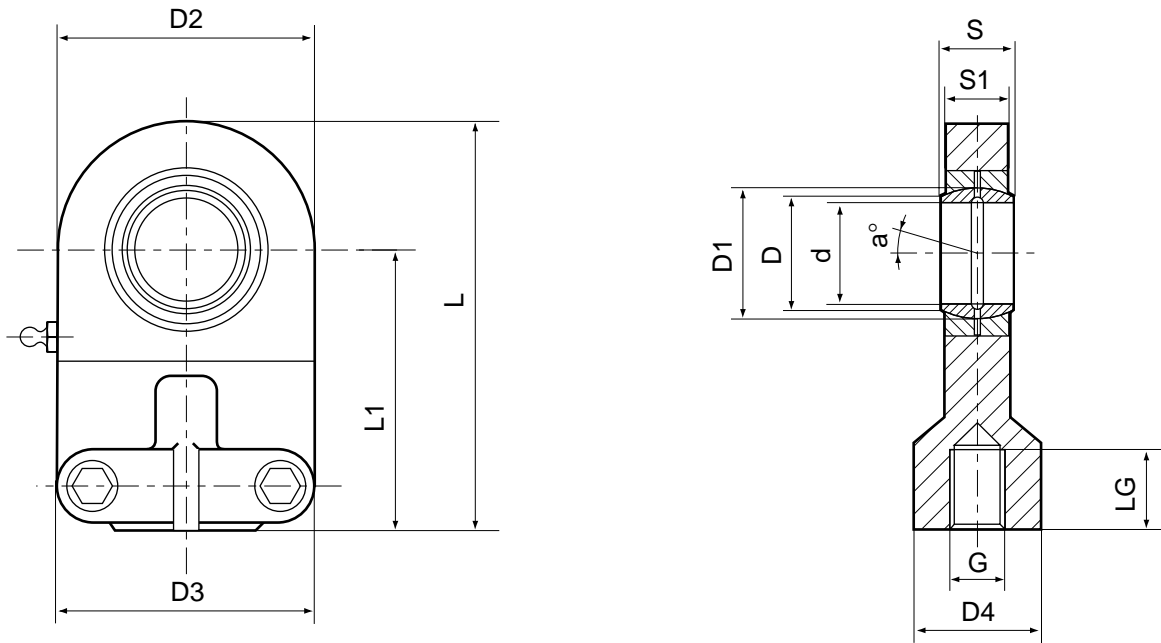

<b>TIPO AI</b>	<b>G</b>	<b>d</b>	<b>D</b>	<b>D1</b>	<b>D2</b>	<b>D3</b>	<b>D4</b>	<b>S</b>	<b>S1</b>	<b>L</b>	<b>L1</b>	<b>LG</b>	<b>a°</b>
<b>AI-012</b>	10 x 125	12	15	18	35	35	17	9	8	59,5	42	15	11
<b>AI-016</b>	12 x 125	16	20,5	25	45	45	21	10	11	70,5	48	17	10
<b>AI-020</b>	14 x 150	20	24	29	55	55	25	16	13	85,5	58	19	9
<b>AI-025</b>	16 x 150	25	29	35,5	65	65	30	20	17	100,5	68	23	7
<b>AI-030</b>	20 x 150	30	34	47,7	80	80	36	22	19	125	85	29	6
<b>AI-040</b>	27 x 2	40	45	53	100	100	45	28	23	155	105	37	7
<b>AI-050</b>	33 x 2	50	56	66	120	120	55	35	30	190	130	46	6
<b>AI-060</b>	42 x 2	60	66,5	80	160	160	68	44	38	230	150	57	6
<b>AI-080</b>	48 x 2	80	89	105	205	205	90	55	47	287	185	64	6
<b>AI-100</b>	64 x 3	100	109,5	130	240	240	110	70	57	360	240	86	6

CILCOIL, S.A. - se reserva el derecho de modificar: Técnica, material, cotas y formas sin previo aviso.

CILCOIL, S.A. - reserves the rights to modify: Techniques, materials, dimensions and shapes without prior notice.

