

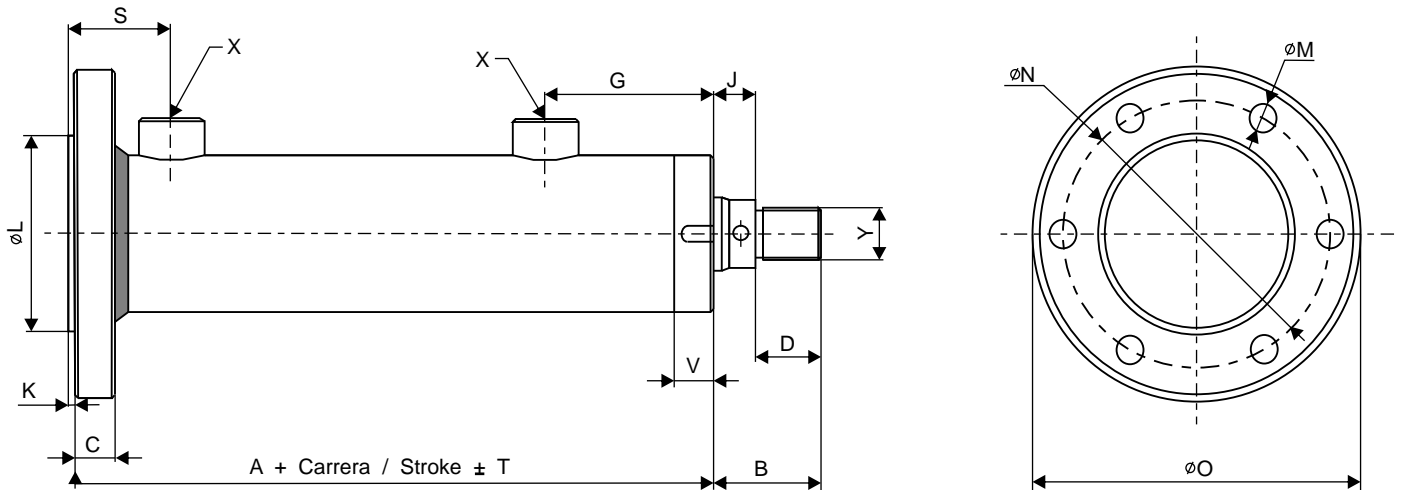

TIPO / TYPE: BS

Brida trasera / Rear flange mounting



Nota: El cilindro serie: CG-250 lleva 12 taladros equidistantes (M) en vez de 6.
Note: The cylinder series:CG-250 carries 12 equidistant drills (M) instead of 6.

| TIPO CG | X | Y | A | B | C | D | G | J | K | L | M | N | O | S | T | V | W | |
|---------|-----|-----------|----------|-----|-----|----|-----|-----|----|---|-----|----|-----|-----|-----|---|----|-----|
| CG-032 | 16 | 1/4" G | 12 X 125 | 110 | 30 | 10 | 16 | 50 | 14 | 2 | 52 | 7 | 67 | 80 | 30 | 2 | 10 | 42 |
| CG-040 | 022 | 3/8" G. | 16 X 150 | 133 | 35 | 13 | 20 | 62 | 15 | 2 | 60 | 9 | 82 | 100 | 32 | 2 | 15 | 50 |
| | 028 | | | | | | | | | | | | | | | | | |
| CG-050 | 028 | 3/8" G. | 20 X 150 | 144 | 41 | 15 | 25 | 64 | 16 | 2 | 75 | 11 | 103 | 125 | 39 | 2 | 15 | 60 |
| | 036 | | | | | | | | | | | | | | | | | |
| CG-063 | 036 | 1/2" G. | 27 X 2 | 157 | 48 | 18 | 32 | 64 | 16 | 2 | 90 | 13 | 120 | 145 | 43 | 2 | 15 | 75 |
| | 045 | | | | | | | | | | | | | | | | | |
| CG-080 | 045 | 1/2" G. | 33 X 2 | 178 | 59 | 22 | 40 | 74 | 19 | 2 | 110 | 15 | 142 | 170 | 50 | 2 | 15 | 95 |
| | 056 | | | | | | | | | | | | | | | | | |
| CG-100 | 056 | 3/4" G. | 42 X 2 | 197 | 70 | 25 | 50 | 84 | 20 | 3 | 135 | 17 | 170 | 202 | 53 | 3 | 16 | 115 |
| | 070 | | | | | | | | | | | | | | | | | |
| CG-125 | 070 | 3/4" G. | 52 X 2 | 210 | 80 | 30 | 55 | 88 | 25 | 3 | 168 | 21 | 210 | 250 | 64 | 3 | 20 | 145 |
| | 090 | | | | | | | | | | | | | | | | | |
| CG-160 | 090 | 1" G. | 68 X 3 | 263 | 100 | 38 | 70 | 112 | 30 | 3 | 215 | 29 | 270 | 320 | 80 | 3 | 20 | 185 |
| | 110 | | | | | | | | | | | | | | | | | |
| CG-200 | 110 | 1 1/4" G. | 90 X 3 | 299 | 125 | 42 | 90 | 127 | 35 | 3 | 270 | 32 | 330 | 385 | 92 | 3 | 25 | 230 |
| | 140 | | | | | | | | | | | | | | | | | |
| CG-250 | 140 | 1 1/4" G. | 110 X 3 | 345 | 150 | 55 | 110 | 155 | 40 | 5 | 330 | 29 | 390 | 440 | 110 | 4 | 30 | 298 |
| | 180 | | | | | | | | | | | | | | | | | |

CILCOIL,S.A.- Se reserva el derecho de modificar: Técnica, material, cotas y formas sin previo aviso.
CILCOIL,S.A.- Reserves the rights to modify: Techniques, materials,dimensions and shapes without prior notice.