

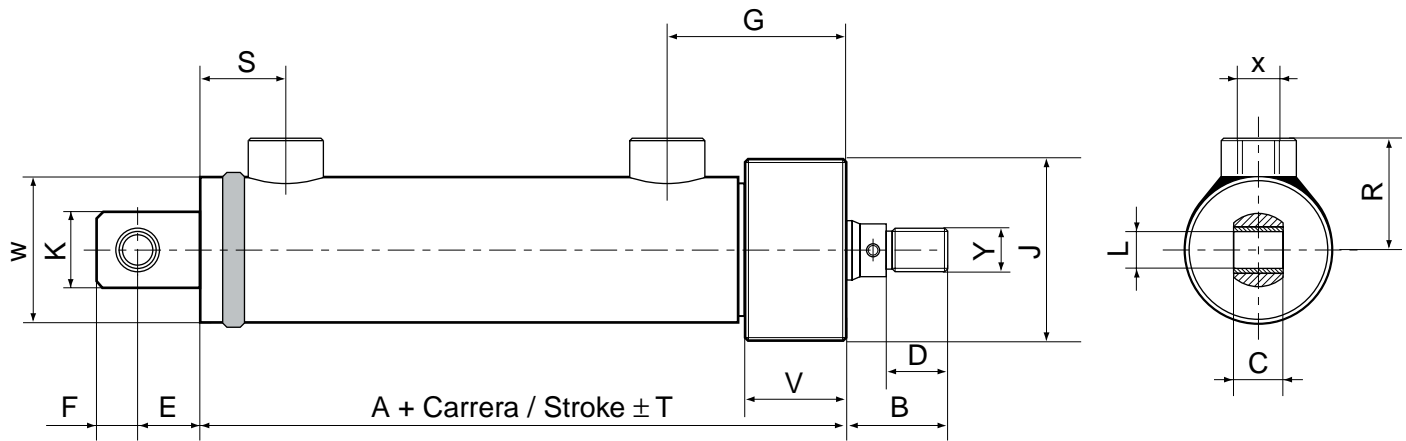

• **TIPO - TYPE: DS** •
Charnela macho - Eye mounting



TIPO CS	X	Y	A	B	C	D	E	F	G	J	K	L	R	S	T	V	W	
CS-032	$\frac{016}{016}$	1/4" G.	12x125	106	30	16	16	20	13	50	52	26	12	35	26	2	32	42
CS-040	$\frac{022}{028}$	3/8" G.	16x150	126	35	20	20	25	16	62	62	32	16	41	25	2	40	50
CS-050	$\frac{028}{036}$	3/8" G.	20x150	136	41	25	25	28	20	64	74	40	20	46	29	2	41	60
CS-063	$\frac{036}{045}$	1/2" G.	27 x 2	149	48	32	32	32	25	64	89	50	25	54	35	2	39	75
CS-080	$\frac{045}{056}$	1/2" G.	33 x 2	168	59	40	40	45	32	74	112	64	32	65	40	2	46	95
CS-100	$\frac{056}{070}$	3/4" G.	42 x 2	189	70	50	50	55	40	84	135	80	40	76	45	3	52	115
CS-125	$\frac{070}{090}$	3/4" G.	52 x 2	203	80	60	55	65	50	88	170	100	50	91	57	3	53	145
CS-160	$\frac{090}{110}$	1" G.	68 x 3	255	100	80	70	75	63	112	218	126	63	116	72	3	67	185
CS-200	$\frac{110}{140}$	1 1/4" G.	90 x 3	297	125	100	90	95	80	127	272	160	80	138	90	3	80	230
CS-250	$\frac{140}{180}$	1 1/4" G.	110 x 3	338	150	120	110	130	100	155	335	200	100	172	103	4	105	298

CILCOIL, S.A. - se reserva el derecho de modificar: Técnica, material, cotas y formas sin previo aviso.

CILCOIL, S.A. - reserves the rights to modify: Techniques, materials, dimensions and shapes without prior notice.